



MicroSurvey CAD 2020

Features and Benefits

4 November 2019

Contents

MicroSurvey CAD 2020	3
New: IntelliCAD 9.2	4
New: Arc Labeling with ArcAlignedText	5
Enhanced: Coordinate System Engine	6
Enhanced: Point Cloud Engine	7
Fixed: AutoMap Library.....	8
Fixed: Active Traverse Editor.....	8
Fixed: ASCII Export	8
Fixed: Lot Closure	8

MicroSurvey CAD 2020

Release Date: October 31, 2019

MicroSurvey CAD provides users with unencumbered survey drafting and calculation workflows, including COGO, point tools for gridline-based projects, traverse input and adjustment, misclosure reporting, common data collector support, 3D surface representation and computation, corridor design, point cloud management, and more. MicroSurvey CAD is perpetually licensed and is powered by IntelliCAD[®] which is compatible with AutoCAD[®] drawing files. With five available feature levels – Basic, Standard, Premium, Ultimate and Studio – MicroSurvey CAD gives users the choice between several tiers of features to ensure they are getting precisely the tools and price point they need.



New: IntelliCAD 9.2

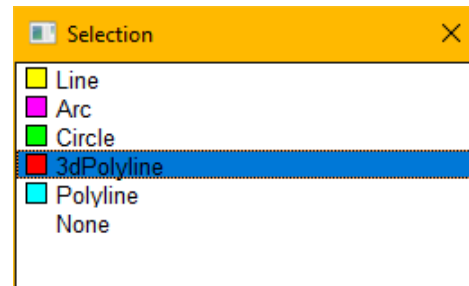
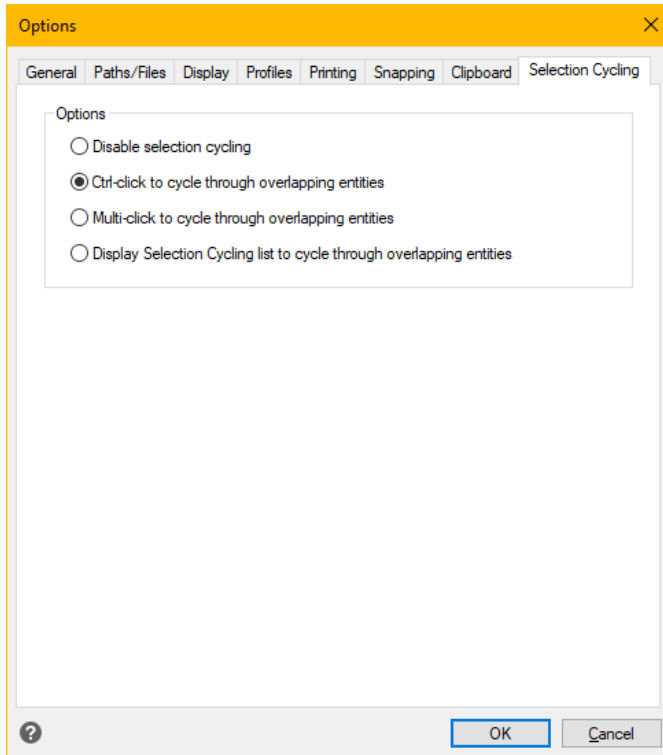

Feature	Benefit
AutoCAD 2018 .dwg files	Open, edit, and save AutoCAD 2018 format .dwg files for maximum compatibility with AutoCAD 2018-2020 products. Includes new support for DWF and DWFx file types.
BIM Models	New object types, as well as elevation lines and section lines to review 3D entities.
Selection Cycling	New options for selection cycling are available from the Options dialog
Undo/Redo Lists	Undo/Redo now contain lists of commands, allowing the user to undo/redo several operations at once.
Digital Signatures	Digital signatures are now able to be applied to .dwg files for protection
Clean Screen	The user may now hide the ribbon and command line in a single button click.
Blocks	A new block editor is included, and users may access blocks from tool palettes.
Start Page	A start page displays recent projects and helpful tips.
Clickable Keywords	Certain commands contain clickable keywords so the user does not need to type to complete the prompts.

New: Arc Labeling with ArcAlignedText

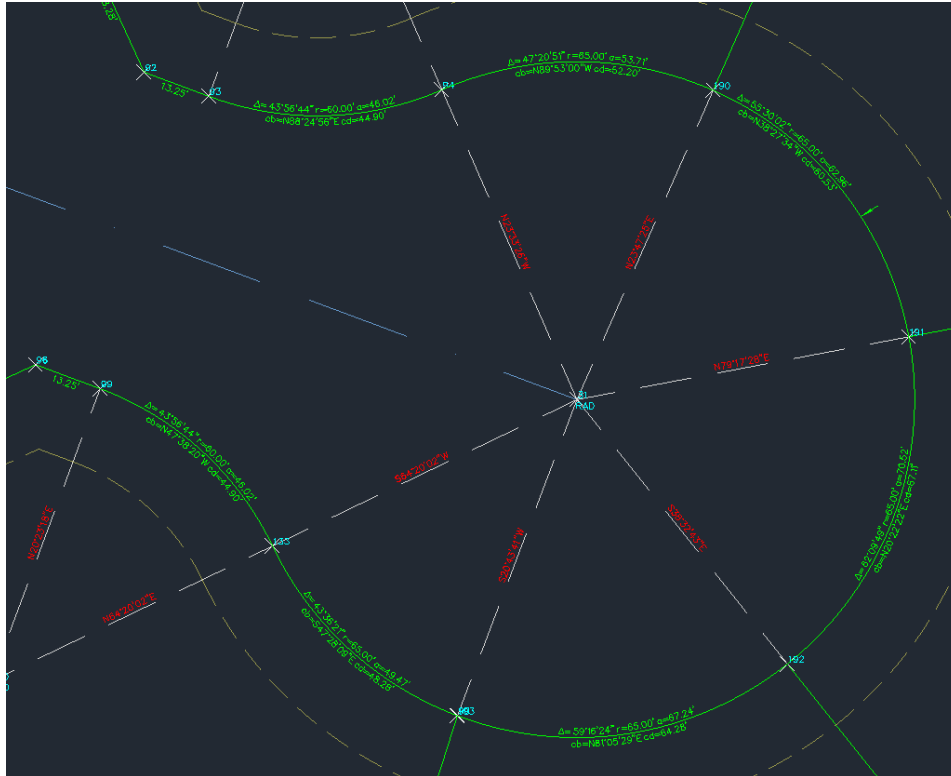

Feature	Benefit
Label on Arc (Manual Label on Arc)	Label On Curve now uses ArcAlignedText objects, rather than several individual single-line text objects to annotate an arc.
Label on Arc	Label On Curve now applies ArcAlignedText objects to polyline arcs, not just Arc entities.
Text on Arc	Text on Arc now uses ArcAlignedText objects, rather than several individual single-line text objects to annotate an arc.
Slide Text	ArcAlignedText labels may now be slid along an arc (or polyline arc) and in/out from the radius point to reposition the label
Rotate Text	ArcAlignedText labels may now be flipped upside down as a single object, just like single-line text labels would.
Lot Closure	The lot closure tool will now detect ArcAlignedText labels for auto-entry
ArcAlignedText Editing	The user may use the IntelliCAD ArcText command to edit ArcAlignedText labels

Enhanced: Coordinate System Engine

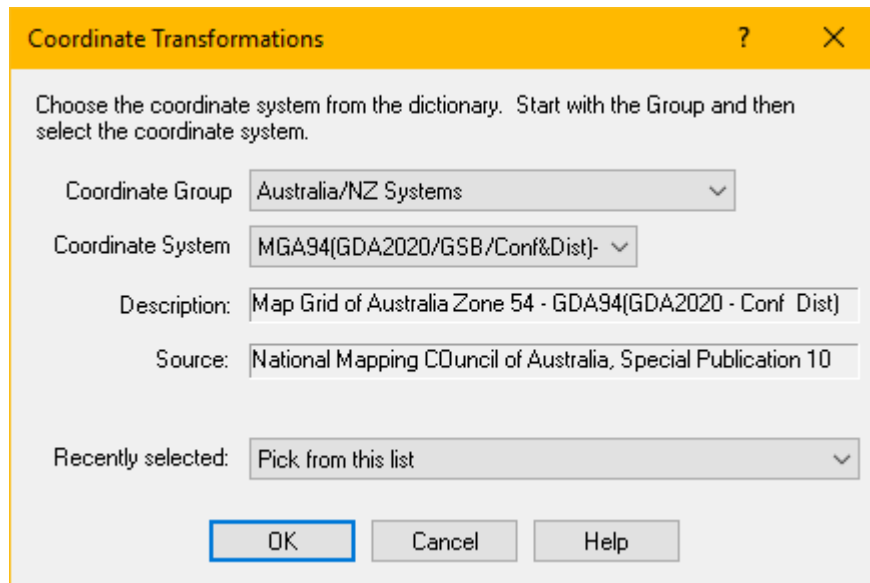

Feature	Benefit
CSMap Coordinate System Engine	The coordinate system engine has been upgraded and now includes over 125 new coordinate systems, which are primarily situated in Africa, Asia, Australasia, Europe, and the USA.

Enhanced: Point Cloud Engine



Feature	Benefit
Point Cloud Engine	The point cloud engine has been updated to Leica EpcA 3.4, and supports Leica Cyclone 9.4, Leica JetStream 1.5, and Leica Cyclone REGISTER 360 1.5. Older versions are still supported.

Fixed: AutoMap Library

Feature	Benefit
AutoMap Library	Deleting the last code in an AutoMap library could cause a crash
AutoMap Library	Creating a new library would display the wrong image preview until a new code was created.

Fixed: Active Traverse Editor

Feature	Benefit
Refresh	Clicking the refresh button could cause a string of error messages
Adjust Traverse Scans	Adjusting traverse scans would cause the point cloud(s) to disappear and be removed from the drawing

Fixed: ASCII Export

Feature	Benefit
ASCII Export	Certain combinations when exporting an ASCII file could cause an unexpected conversion from feet to meters

Fixed: Lot Closure

Feature	Benefit
Lot Closure	Deleting a lot closure now also deletes its corresponding .txt file from the database
Lot Closure	The lot closure report now honours the "List E,N (X,Y) Format" system toggle.